

PSH100A100A SERIES

Enclosed Dual 100 VA Power Supplies, 120 to 24 Vac



Class II



Model Shown:
PSH100A100AB10

Functional Devices, Inc. A600A 2003

GENERAL SPECIFICATIONS

Transformers: Two 100VA Split-Bobbin
Primary: 120 Vac
Secondary: 24 Vac, w/ LED Indicators
24 Vac ON/OFF: Switch / Breaker (4 Amp)
Main Breaker ON/OFF: Switch / Breaker (10 Amp)
Outputs: Outlets (2)
 Aux. Output Wire (1)
 Total Combined Output 9A
Approvals: Class II UL Listed, UL916, C-UL Canada
Dimensions: W=8.25", H=4.25", D=3.75"
Weight: 8.5 lbs.

INPUT WIRES

"B10" Models Only

All Other Models

INPUT POWER WIRES

PRIMARY WIRES

OUTLET WIRES

Black: 120 Vac

Black: 120 Vac

Black: 120 Vac

White: Neutral

White: Common

White: Neutral

Green: Ground

Green: Ground

PSH100A100A SELECTION GUIDE

Model #	120 Vac Outlets	Aux. Output Wire	Main Breaker On Input Power	Secondary Configuration
PSH100A100A	•			External Terminal Strip
PSH100A100AN				External Terminal Strip
PSH100A100ANW				Internal Wires
PSH100A100AW	•			Internal Wires
PSH100A100AB10	•	•	10A Switch / Breaker	External Terminal Strip
PSH100A100ANB10		•	10A Switch / Breaker	External Terminal Strip
PSH100A100ANWB10		•	10A Switch / Breaker	Internal Wires
PSH100A100AWB10	•	•	10A Switch / Breaker	Internal Wires

OUTPUT WIRES

"B10" Models Only

"W" Models Only

120 Vac, 1 Aux. Output Wire (Blue)

24 Vac, 2 Wires (White/Yellow)

NOTES

Mounting plate included with all models. See page 130 for mounting instructions.

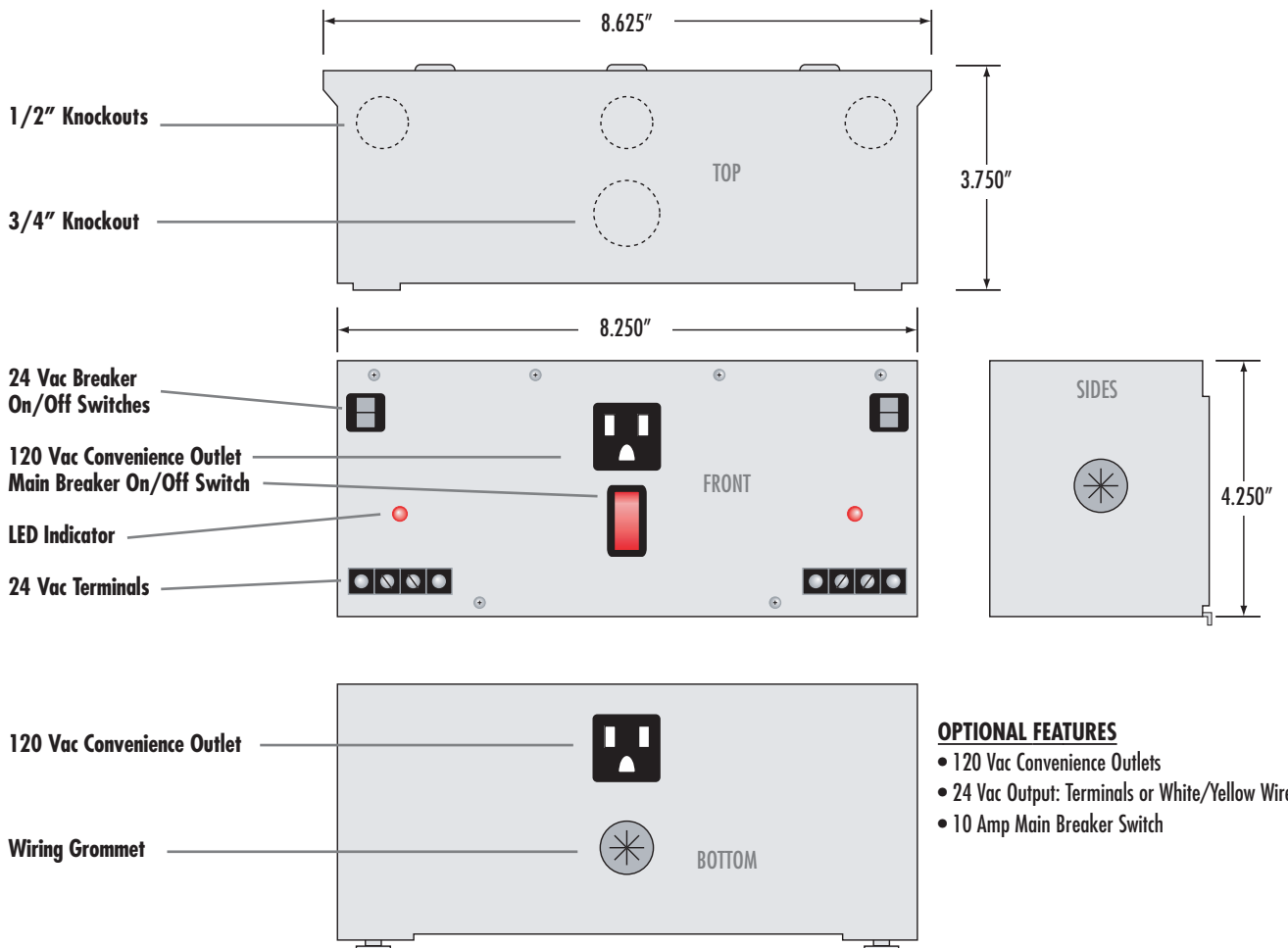

OPTIONAL FEATURES

- 120 Vac Convenience Outlets
- 24 Vac Output: Terminals or White/Yellow Wires
- 10 Amp Main Breaker Switch